

PURPOSE:	DIVISION	AREA NAME:	ANGLE VALE	RE-APPROVED:	 D121973 SHEET 1 OF 4 66602_text_01_v07_Version_7
MAP REF:	6628/19/C, 6628/12/P, 6628/19/B, 6628/12/Q	COUNCIL:	CITY OF PLAYFORD	BILL SHEEKY 19/09/2019	
LAST PLAN:		DEVELOPMENT NO:	292/D024/17/001/56272	DEPOSITED:	
				SANDY BEAGLEHOLE 25/09/2019	

AGENT DETAILS:	ALEXANDER & SYMONDS PTY LTD 1ST FLOOR 11 KING WILLIAM ST KENT TOWN SA 5067 PH: 81301666 FAX: 83620099	SURVEYORS CERTIFICATION:	I DAMIAN JOHN HOLLAND , a licensed surveyor do hereby certify - 1) That this plan has been made from surveys carried out by me or under my personal supervision and in accordance with the Survey Act 1992. 2) That the field work was completed on the 15th day of January 2018 19th day of September 2019 Damian Holland Licensed Surveyor
AGENT CODE:	ALSY		
REFERENCE:	A154416LTO1(B)		

SUBJECT TITLE DETAILS:										
PREFIX	VOLUME	FOLIO	OTHER	PARCEL	NUMBER	PLAN	NUMBER	HUNDRED / IA / DIVISION	TOWN	REFERENCE NUMBER
CT	5171	51		ALLOTMENT(S)	2	F	15026	MUNNO PARA		

OTHER TITLES AFFECTED:

EASEMENT DETAILS:									
STATUS	LAND BURDENED	FORM	CATEGORY	IDENTIFIER	PURPOSE	IN FAVOUR OF	CREATION		
EXTINGUISH	98 IN D23036	LONG	RIGHT(S) OF WAY	B		1-5. 11-18. 501	TG 6674080		
EXTINGUISH	90-98 IN D23036	LONG	EASEMENT(S)	A IN D23036		1-5. 11-18. 501	RE 6538034		
EXTINGUISH	5 IN D38104	LONG	EASEMENT(S)	C IN D38104		1-5. 11-18. 501	RE 6538034		
EXTINGUISH	4. 5 IN D38104	SHORT	EASEMENT(S)	B IN D38104	FOR WATER SUPPLY PURPOSES	1-5. 11-18. 501	RE 7608724		
EXISTING		LONG	RIGHT(S) OF WAY	B		500	TG 6674080		
EXISTING	90-98 IN D23036	LONG	EASEMENT(S)	A IN D23036		500	RE 6538034		
EXISTING		LONG	EASEMENT(S)	C IN D38104		500	RE 6538034		
EXISTING		SHORT	EASEMENT(S)	B IN D38104	FOR WATER SUPPLY PURPOSES	500	RE 7608724		
NEW	501	SERVICE	EASEMENT(S)	C(T/F)	FOR ELECTRICITY SUPPLY PURPOSES	DISTRIBUTION LESSOR CORPORATION (SUBJECT TO LEASE 8890000)	223LG RPA		



D121973

SHEET 2 OF 4

66602_text_01_v07_Version_7

ANNOTATIONS: NO OCCUPATION ON SUBJECT LAND BOUNDARIES UNLESS SHOWN OTHERWISE

REFERENCE MARKS

CNR	BEARING	FROM	DIST	PM NO
1	104°00'	MP FD	8.89	
1	181°13'	PM FD	58.54	6628/40550
2	23°46'	MP FD	1.69	
3	342°36'	MP FD	2.48	
4	214°17'	MP FD	1.81	
5	300°57'	PM FD	0.65	6628/51651
6	160°39'	PM FD	1.45	6628/22266
7	75°37'	PM FD	0.97	6628/2703

NEW FIX
NEW FIX



D121973

SHEET 3 OF 4

66602_pland_1_V02_Version_7

BEARING DATUM: MGA 2020 ZONE 54
DERIVATION: 6628/22868 - 6628/51651

TOTAL AREA: 17.19ha

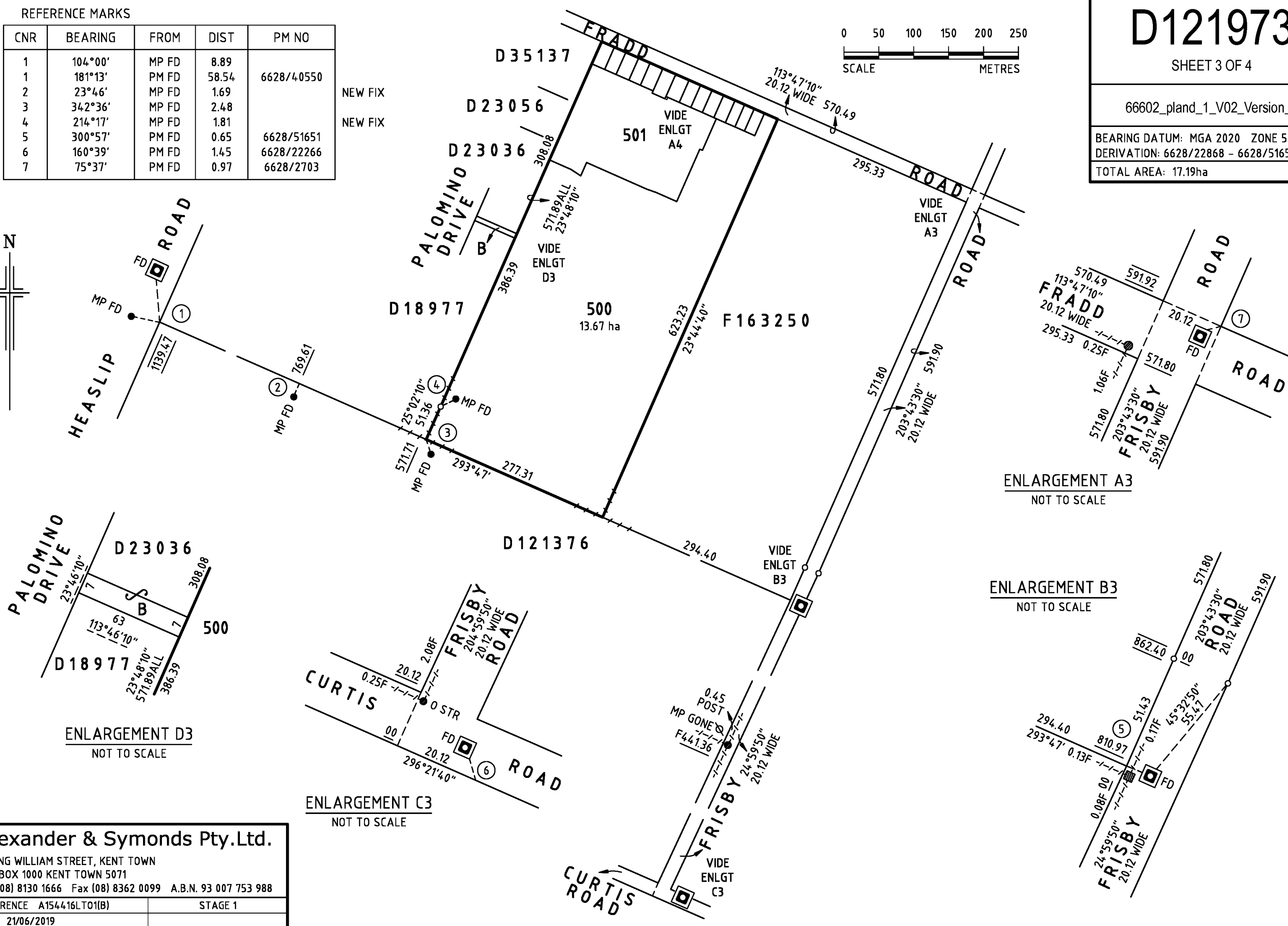
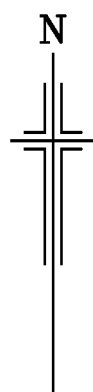

ENLARGEMENT A3
NOT TO SCALE

ENLARGEMENT B3
NOT TO SCALE

ENLARGEMENT D3
NOT TO SCALE

ENLARGEMENT C3
NOT TO SCALE

Alexander & Symonds Pty.Ltd.

11 KING WILLIAM STREET, KENT TOWN
P.O. BOX 1000 KENT TOWN 5071
Tel (08) 8130 1666 Fax (08) 8362 0099 A.B.N. 93 007 753 988

REFERENCE A154416LT01(B) STAGE 1
PAP 21/06/2019

D121973

SHEET 4 OF 4

66602_pland_2_V02_Version_7

REFERENCE MARKS

CNR	BEARING	FROM	DIST	PM NO
8	23°45'	PM FD	0.99	6628/22868
9	204°09'	MP FD	2.01	6628/22868
9	204°58'	PM FD	19.14	6628/22868

NEW FIX

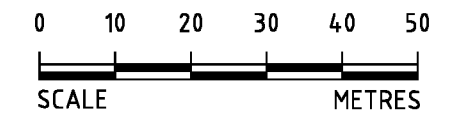

ENLARGEMENT A4

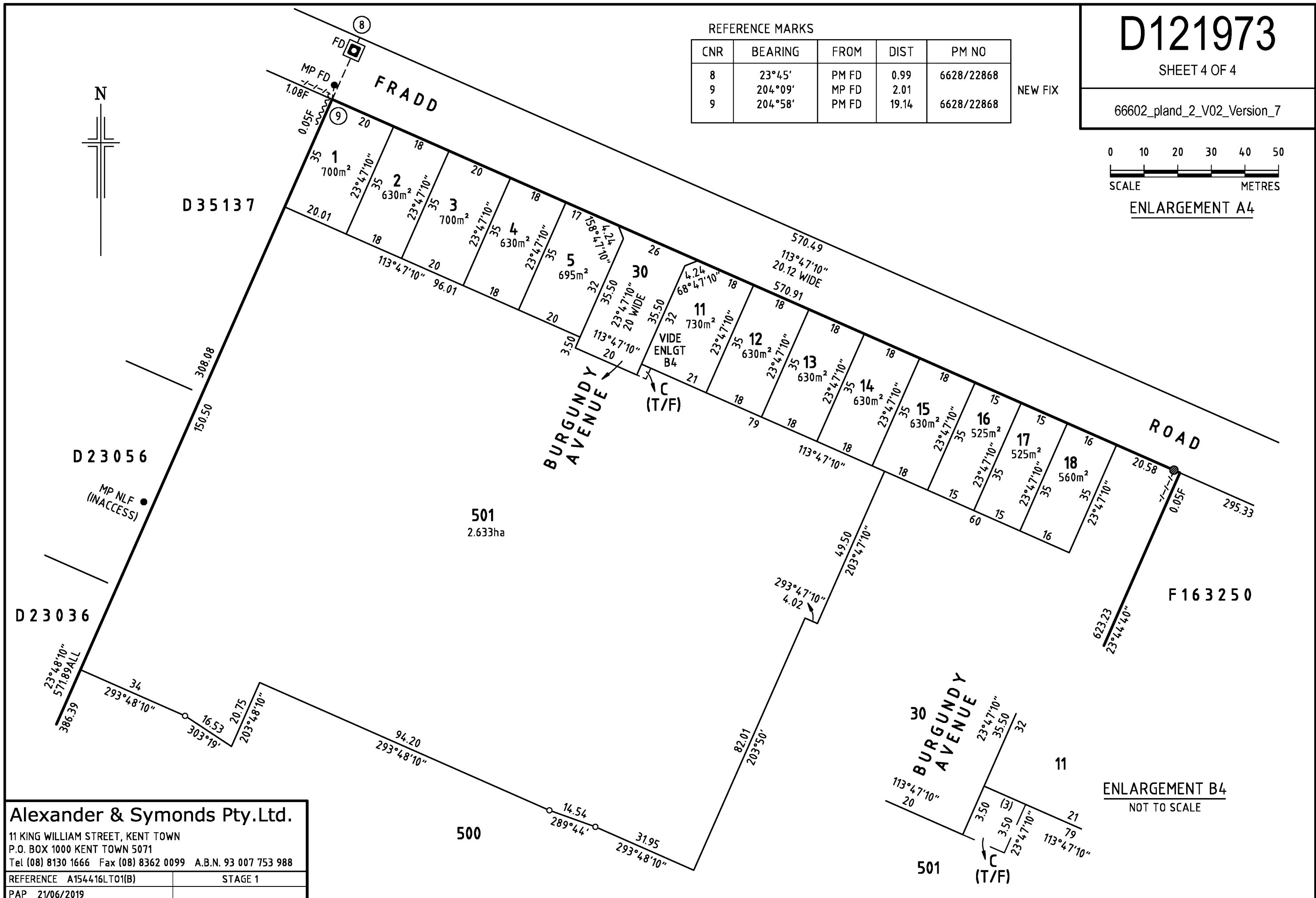
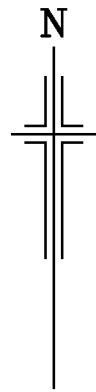

Alexander & Symonds Pty.Ltd.
11 KING WILLIAM STREET, KENT TOWN
P.O. BOX 1000 KENT TOWN 5071
Tel (08) 8130 1666 Fax (08) 8362 0099 A.B.N. 93 007 753 988
REFERENCE A154416LT01(B) STAGE 1
PAP 21/06/2019

ENLARGEMENT B4
NOT TO SCALE